

Hardware	Ctn No.	1
----------	---------	---

No.	Size	Qty
A1	590x180x23mm	1
A2	590x180x23mm	1
B1	575x280x23mm	1
B2	575x293x23mm	1
C1	550x274.5x20mm	1

No.	Size	Qty
C2	550x274.5x20mm	1
D	600x180x38mm	1
E	598x110x20mm	2
F	599x180x23mm	1
G	596x130x20mm	3

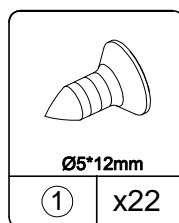

spare:2

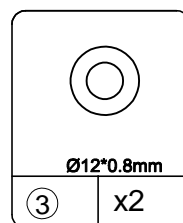
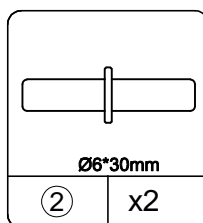

spare:2

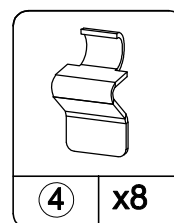

spare:2

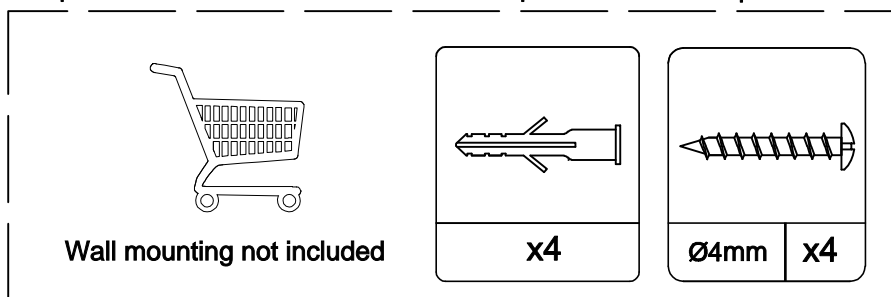

(1) - Attach (E) to (F) as below shown.

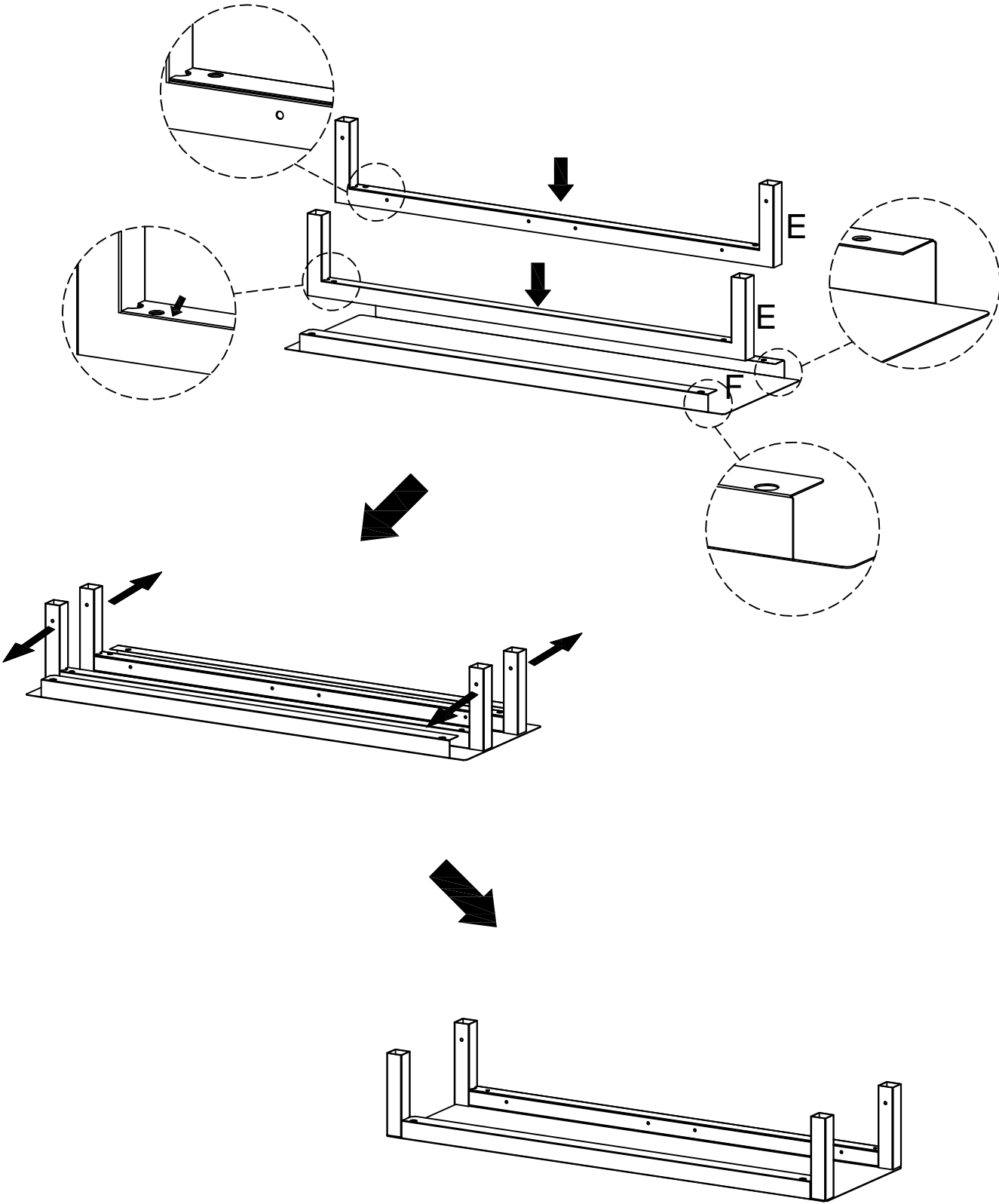

(2) - Attach (A1) & (A2) to (E) as below shown.

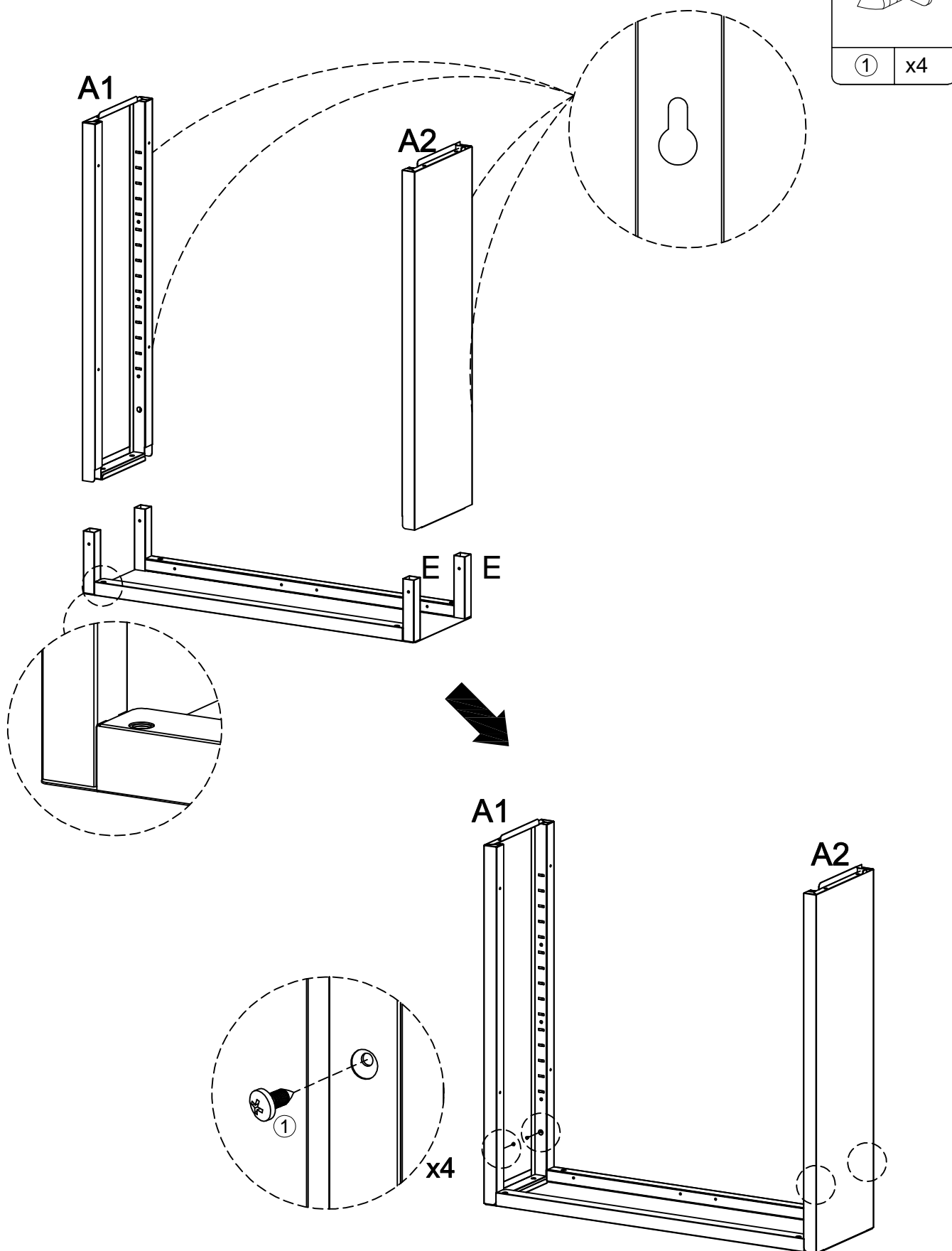

(3) - Attach (B1) & (B2) to (A1) & (A2) & (E) as below shown.

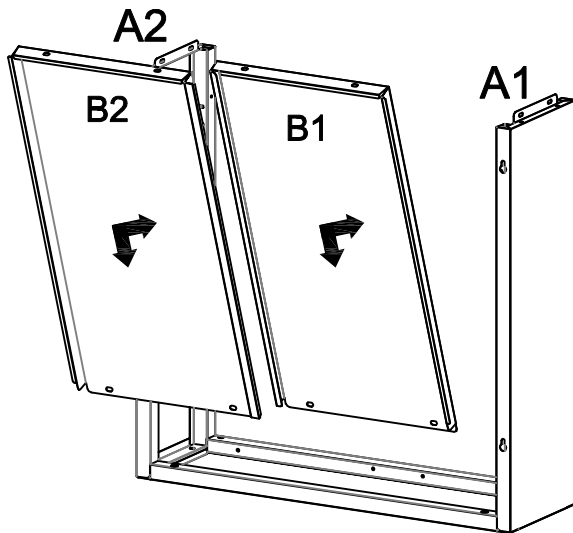
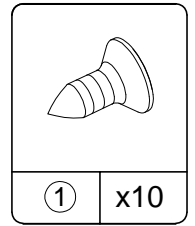

Switch to back view

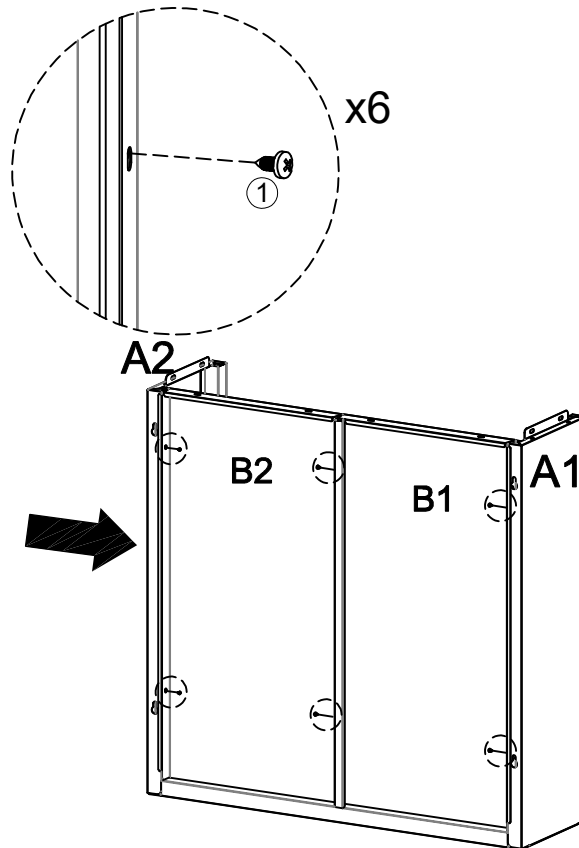

Switch to front view

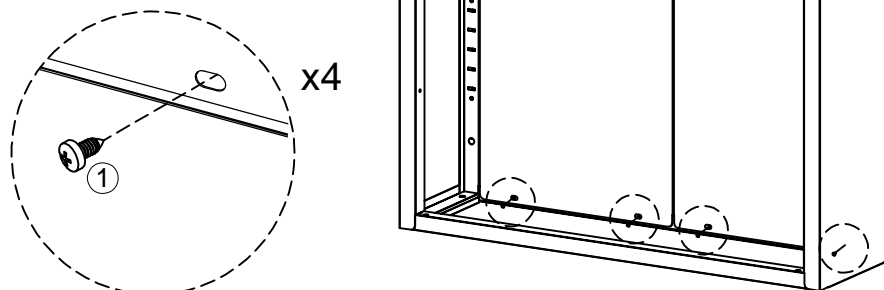

(4) - Attach (D) to (A1) & (A2) & (B1) & (B2) as below shown.

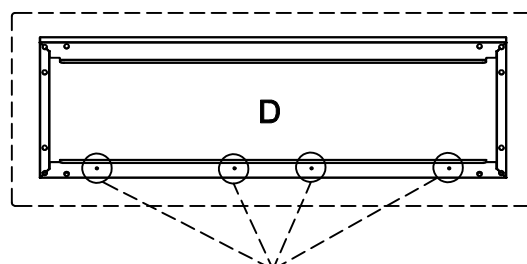
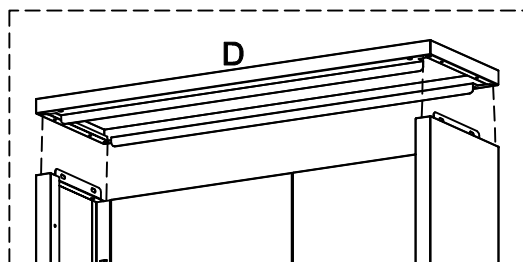
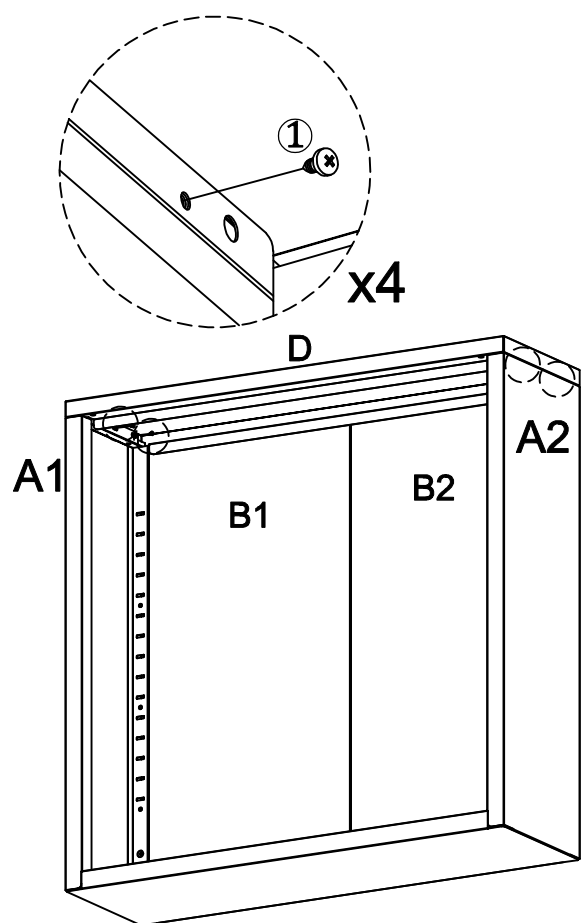
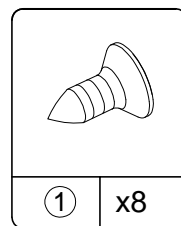

⚠ The back side of (D) with these 4 screw holes

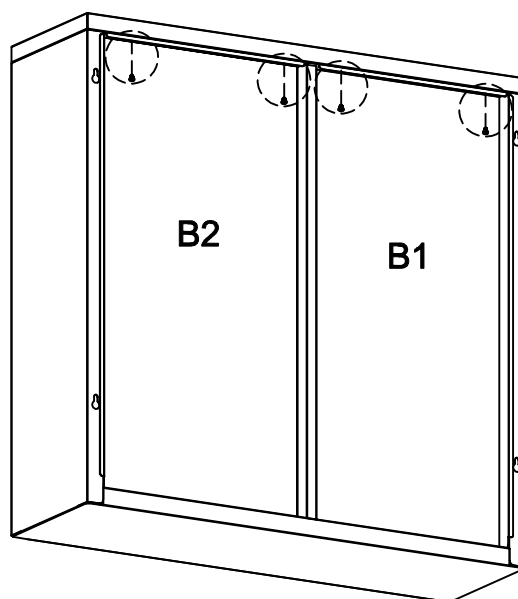
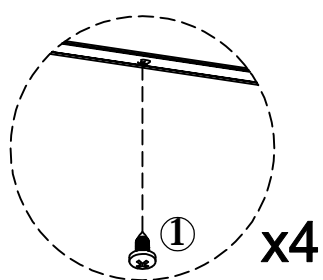

(5) - Attach (A1) & (A2) to wall as below shown.

Align the template in the intended position on the wall and hold it in place using tape.

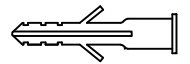
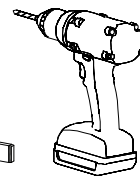

x4

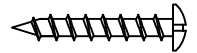

x4

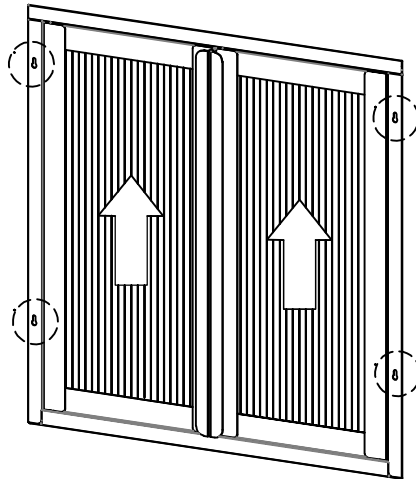

Use a level to ensure it is straight

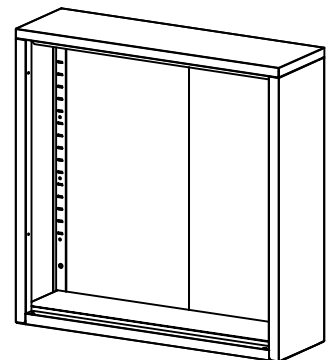
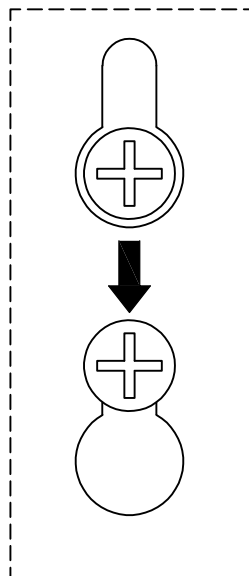
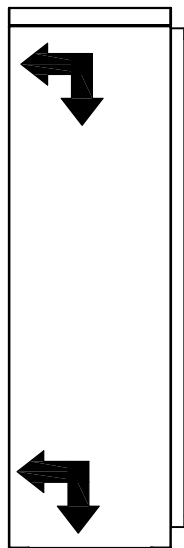
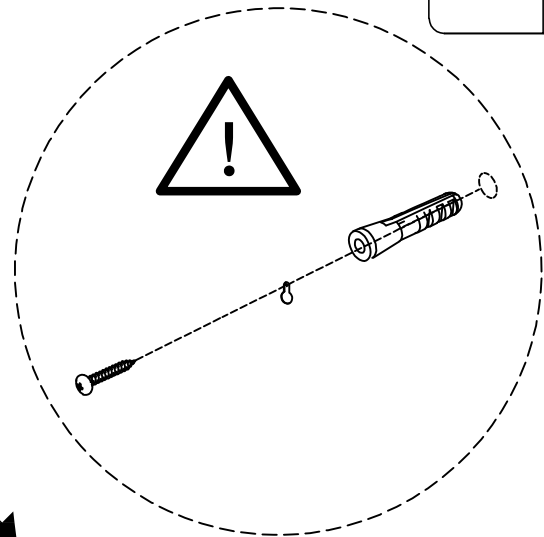

Fix the cabinet securely to the wall. Screws and plugs are not included - use fittings suitable for your wall type. If unsure, ask a professional.

(6) - Attach (G) to pre-assembled unit as below shown.

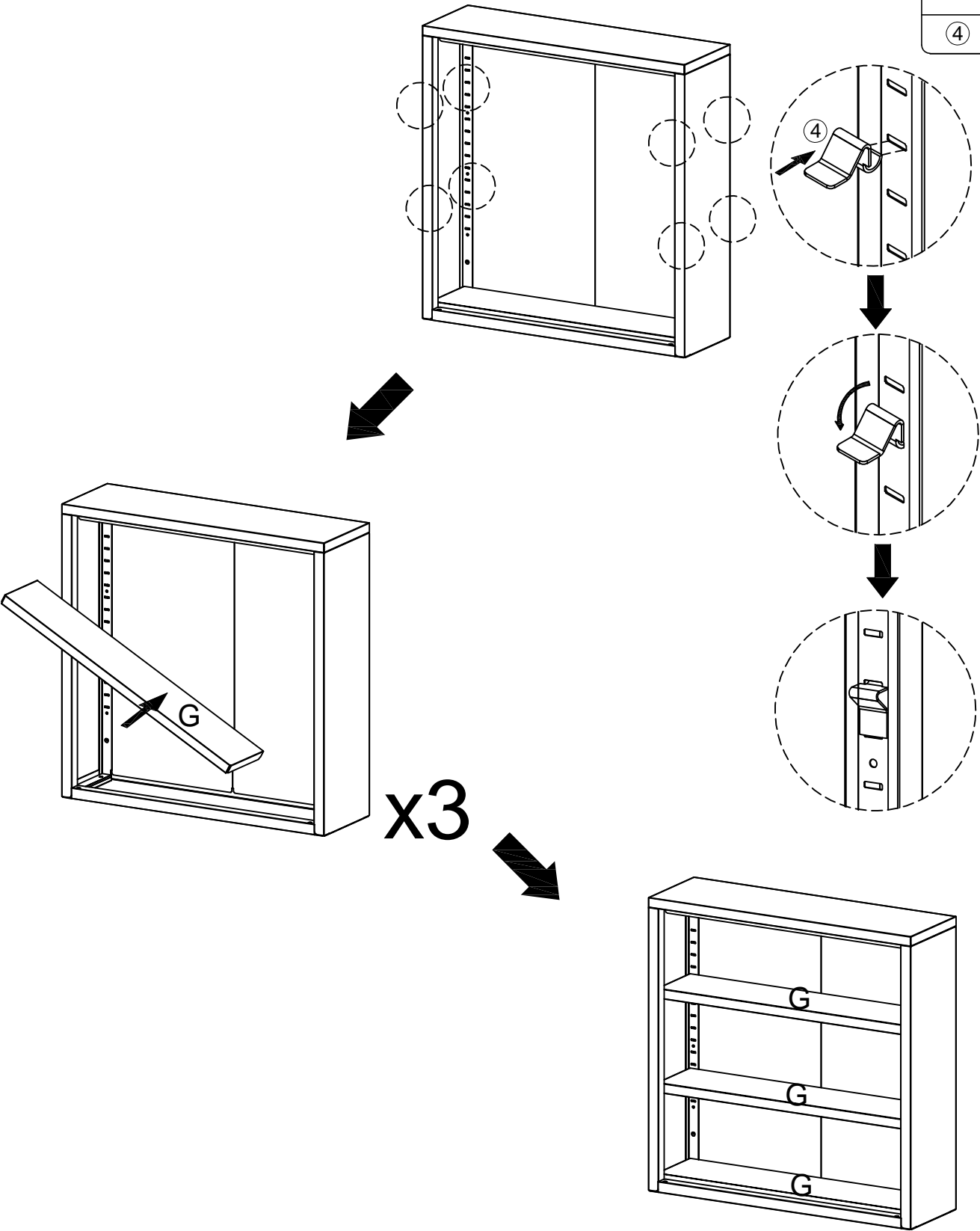
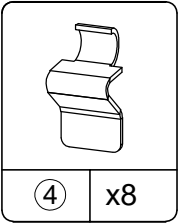

(7) - Attach (C1) & (C2) to pre-assembled unit
as below shown.

